

System Manager

User Manual

Version Information

version	date	state	description	department
V1.0	2023/06/30	N	Establish	Product Management
V1.1	2025/03/05	A	Add drop detection function	Product Management

Note: status can be N-New, A-Add , M-Modify , D-Delete .

Catalogue

1 Product introduction	3
2 Product Description	4
2.1 Application Scenario	4
2.2 Compatible device	5
3 Operation	5
3.1 Main interface	5
3.2 Accelerate	6
3.3 Cleanup	7
3.4 Large file	8
3.5 Battery	9
3.6 APP Management	11
3.7 Permission	12
3.8 Network	13
3.9 Data	14
3.10 Self starting	15
3.11 Fall statistics	15
3.12 Set up	16

1 Product introduction

System Manager is a very practical PDA device management tool that can help users easily clean up application processes, junk files, caches, etc., thereby improving device performance and stability. In addition, it can scan large files in the device, view and monitor battery-related information, manage applications and permissions, support network quality detection, traffic statistics, set device auto-start, etc., with rich and practical functions.

2 Product Description

2.1 Application Scenario

Main functions	Scenario description
memory cleanup	Too many open applications and processes will occupy the device's running memory, which may cause the device to freeze. Use the system manager memory cleaner to easily identify running applications and clean them up as needed.
garbage cleanup	After a device is used for a period of time, a lot of junk files, installation packages and other unnecessary files will accumulate, which will take up the storage space of the device and affect the performance of the device. Use System Manager's Junk Cleanup feature to easily clean up these files, free up storage space and improve device performance.
Battery Status Query	Use the battery-related functions to know the health status of the battery, including the remaining capacity of the battery, the number of times the battery has been charged, and the health of the battery. In addition, you can also check the charging and discharging records, the usage time of each application, etc., and you can set the power saving mode to extend the battery life.
Application and permission management	Through the application management, you can conveniently query information such as the application package name, and perform opening or uninstallation management. Through application permission management, you can query and manage third-party application permissions to better protect privacy.
Network quality and traffic monitoring	Real-time detection of the uplink and downlink speeds of the currently connected network and the traffic consumption statistics of each application.
Equipment Drop Detection	When the device generates a free-fall drop, it records and counts the relevant drop data, including drop time, drop height, and the latitude and longitude of the drop.
Other functional applications	You can quickly set the third-party application to start automatically.

2.2 Compatible device

All Seuic devices with Android system (some devices may fail to get some data).

3 Operation

3.1 Main interface

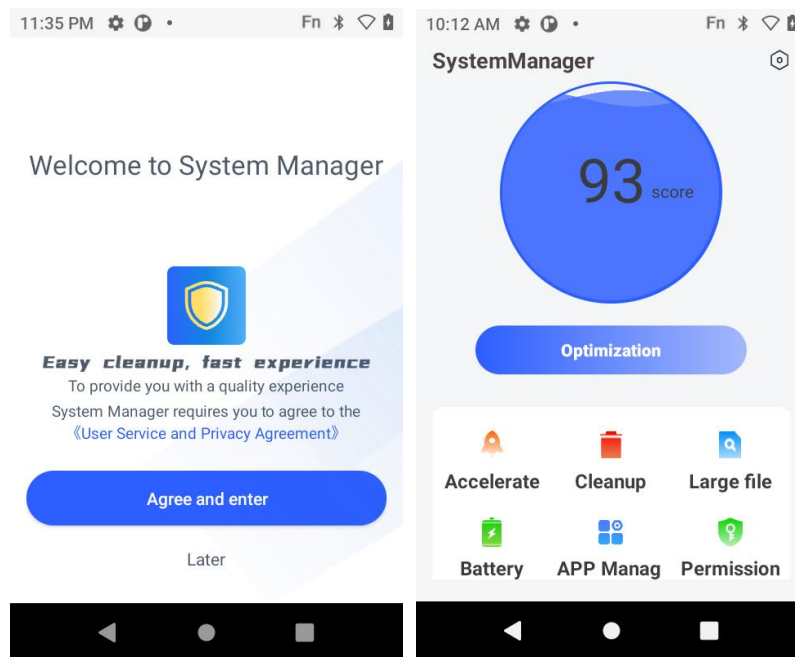

Opening the app for the first time requires the user to agree to the user service and privacy agreement. Click Agree to enter the main interface of the app.

- Score: the score is comprehensively calculated through certain rules such as memory usage ratio, storage usage ratio, etc.;
- Optimization: One-click cleaning of running three-party applications, application caches, junk files, installation packages, etc., to improve the system score.

3.2 Accelerate

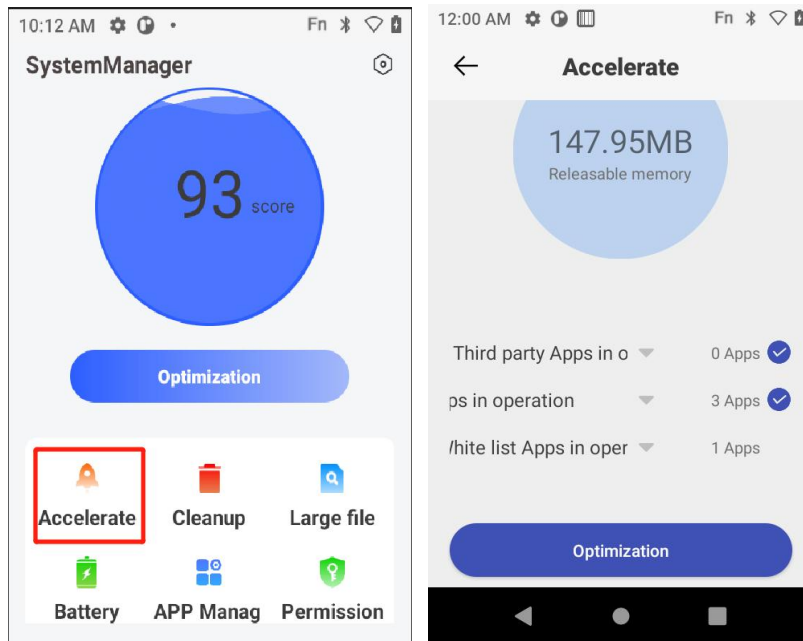

Query and clean up the running applications, and calculate the total memory usage of each application and the selected application. Application types are divided into three-party applications, system applications, and whitelist applications. You can choose the applications to be cleaned by yourself. Click Optimize Now to close the selected application and clean up the memory to achieve the effect of acceleration.

Among them, whitelist applications can be manually added in the settings in the upper right corner of the main interface. In addition, you can connect with Seuic's pre-sales customer manager to open the background management system, and add corresponding cleaning rules in batches through the background management system, such as whitelisting applications, specifying cleaning cache directories, scanning the size of large files, etc.

3.3 Cleanup

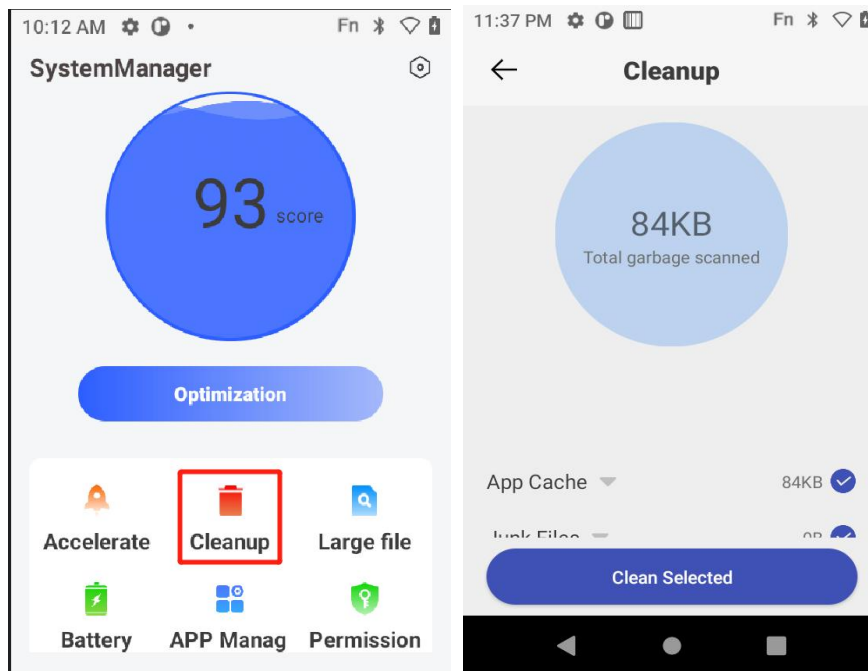

The junk cleaning module can clean up application cache, junk files, and installation packages.

- App cache: Calculate and clear the sum of the file sizes under the cache folder generated by installed applications;
- Junk files: Calculate and clean up the total size of files that meet special conditions in the specified directory. The specified directory is configured by the background management system and can be delivered through the interface or imported locally;
- Apk: scan the entire disk (except the whitelist directory), and display the installation package file of the post-installed application.

3.4 Large file

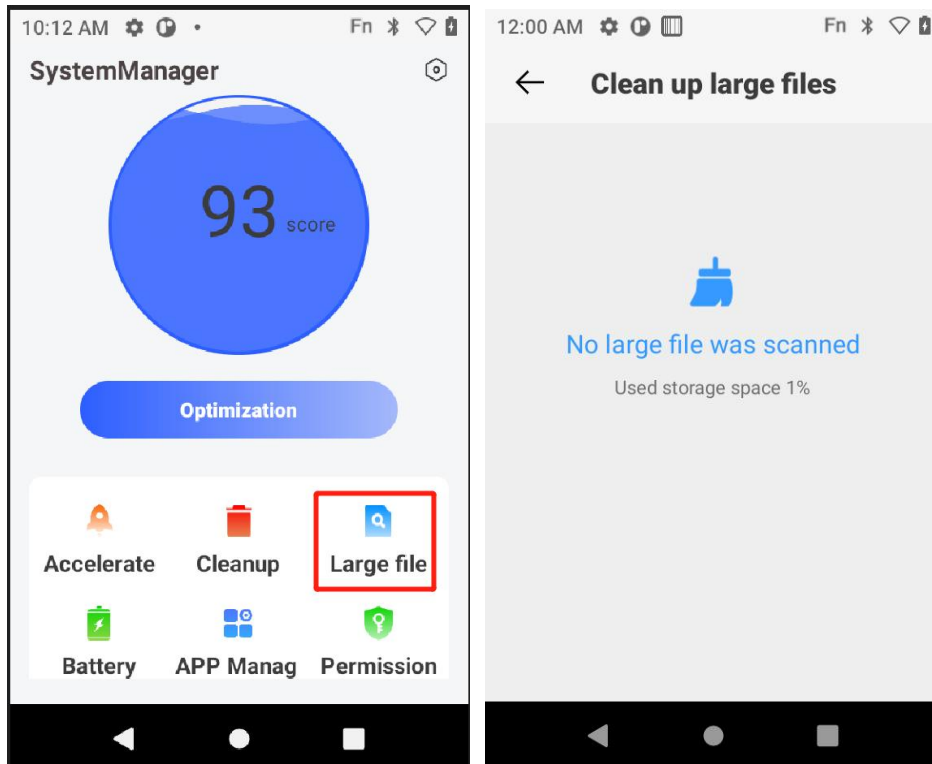

The module for scanning large files can scan all files (excluding white list directories) larger than 100m, and clean them up as needed. If you use a background management system, you can set a large file size.

3.5 Battery

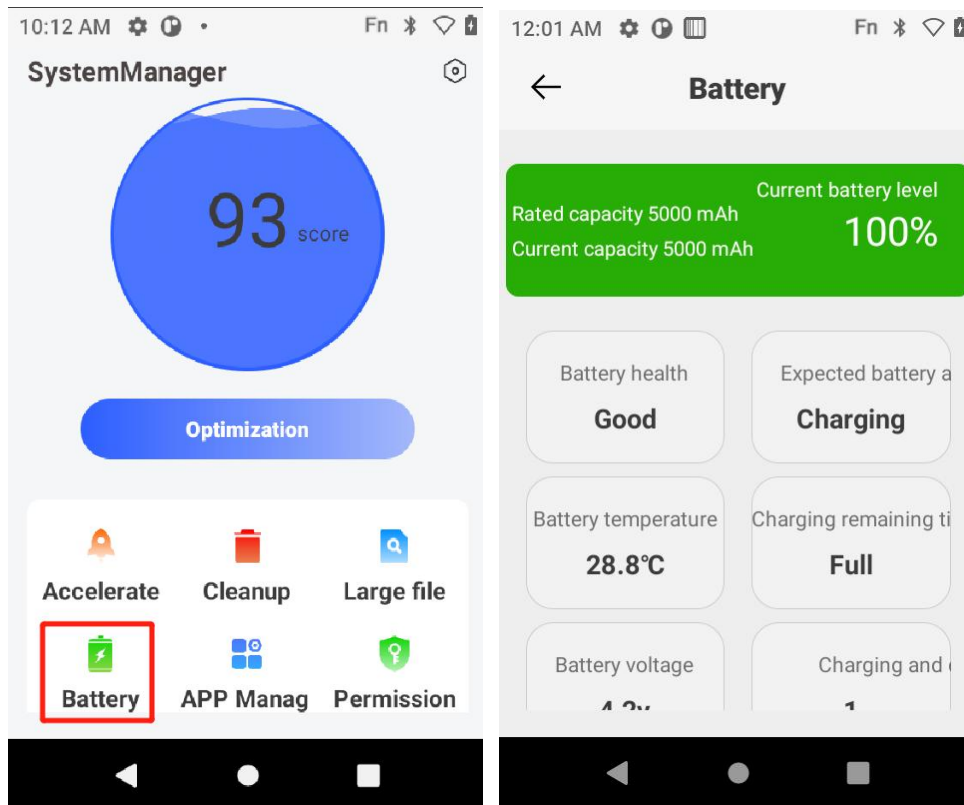

The battery management module displays battery capacity, current power, battery health status, temperature, voltage, estimated usable and full charge time, charge and discharge times, etc. In addition, you can query charge and discharge records, application usage time and set power saving mode (power saving mode can only be set in the uncharged state, and some devices may not support it).

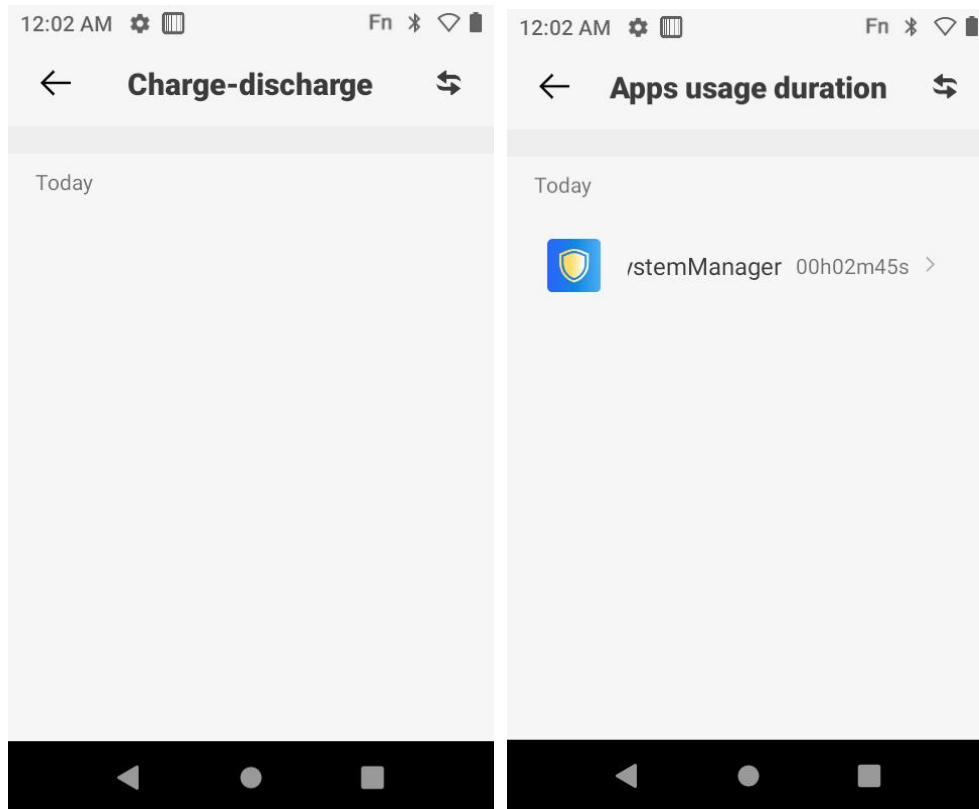

- Charge and discharge record: enter the charge and discharge record page, you can query the history of charge and discharge on the current day, the past 7 days, and the past 30 days (at least 1% of charge or discharge is required), including the start time, duration, and power change of each charge and discharge percentage etc. Click the button in the upper right corner to switch query time.
- Application usage duration: Enter the application usage duration to query the cumulative running time of the applications used in the current day, the past 7 days, and the past 30 days. Click the corresponding application to enter the system application information interface for related operation configuration. Click the button in the upper right corner to switch query time.

3.6 APP Management

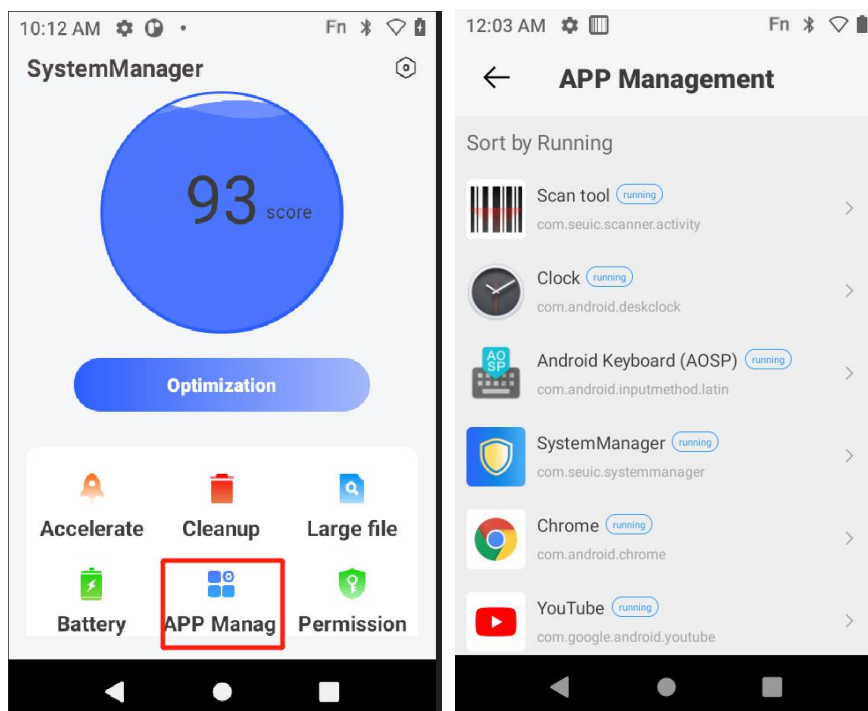

The APP management module displays the list of applications installed in the device, and can query which applications are running. Click to enter the details page, which displays the basic information of the application (including the application package name), and can quickly open the application. Among them, non-system applications can be clicked to uninstall.

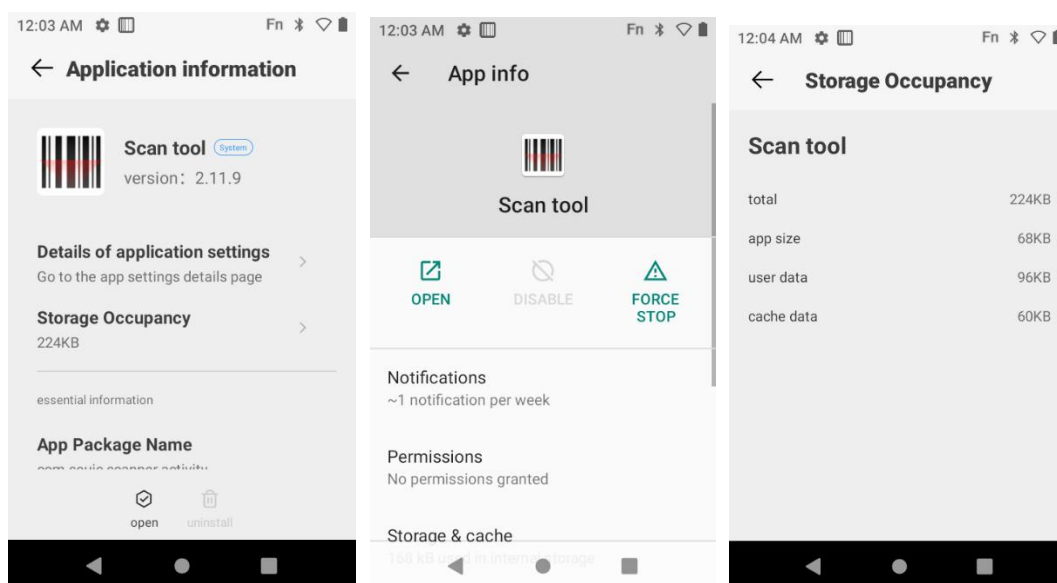

- Details of application settings: Click to enter the application setting details to enter the Android native application management details page;

- Storage occupancy: Click the storage usage page to view the application size, user data usage and cache status.

3.7 Permission

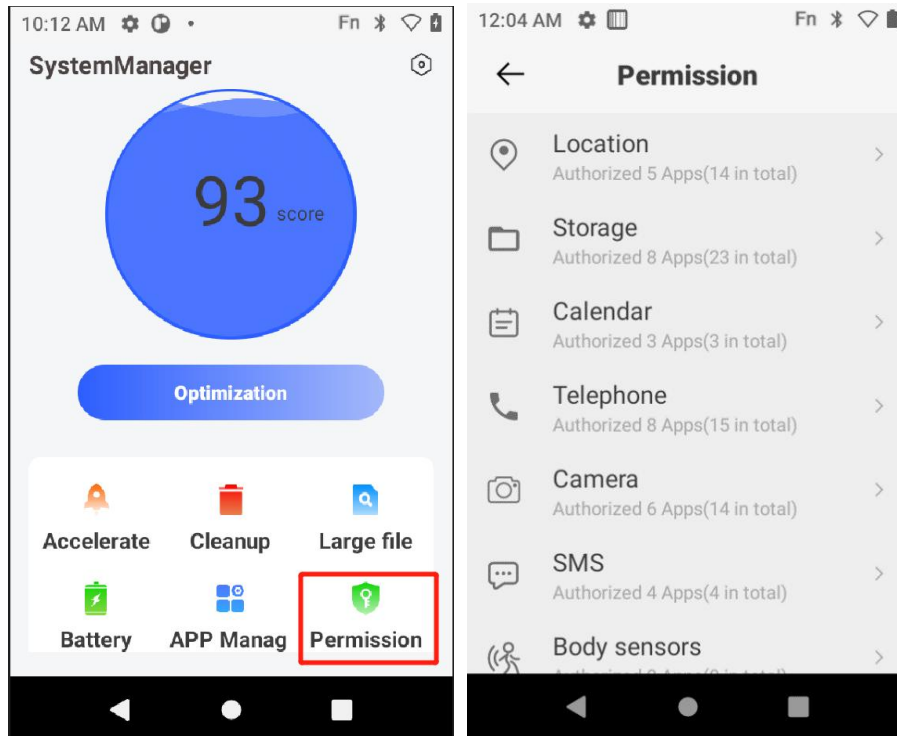

Detect and display commonly used permission groups, you can query the applications that have been authorized by the relevant permission groups, and perform permission authorization control on post-installed applications.

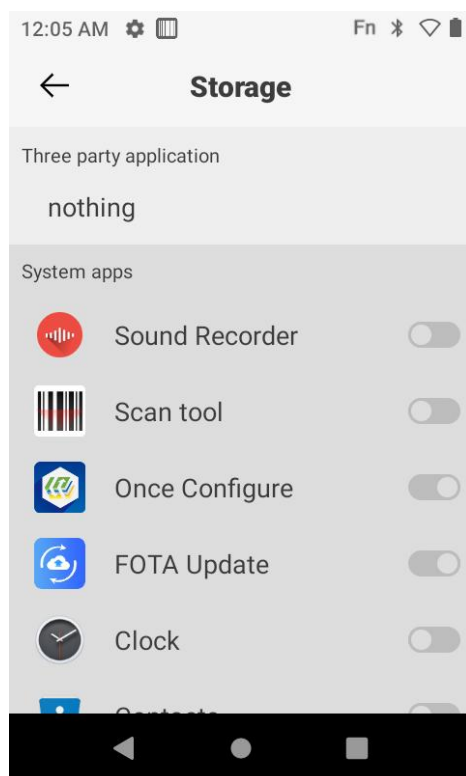

3.8 Network

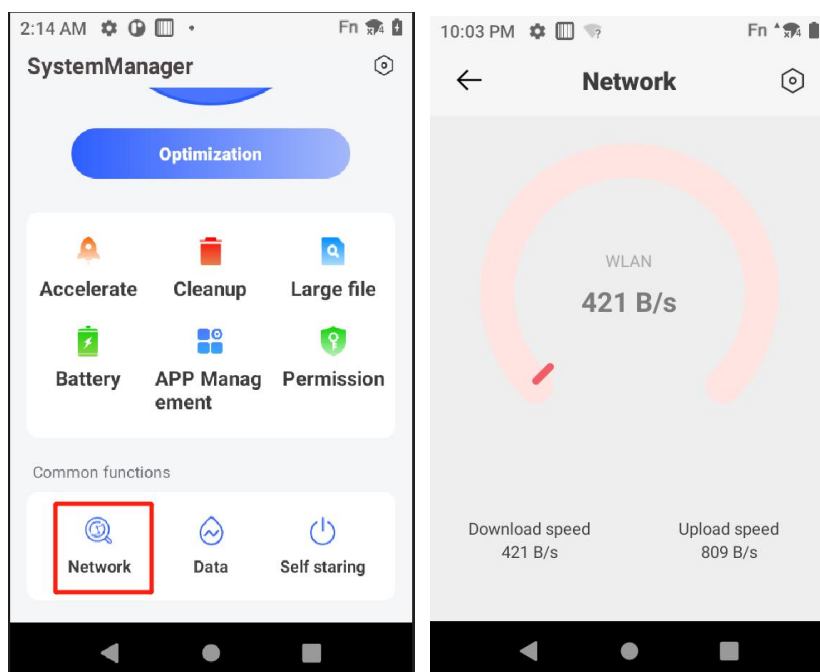

Common functions - the network detection module can detect the uplink and downlink speeds of the currently connected network (mobile network or WLAN). Click the setting button in the upper right corner to set the status bar to display the current network speed.

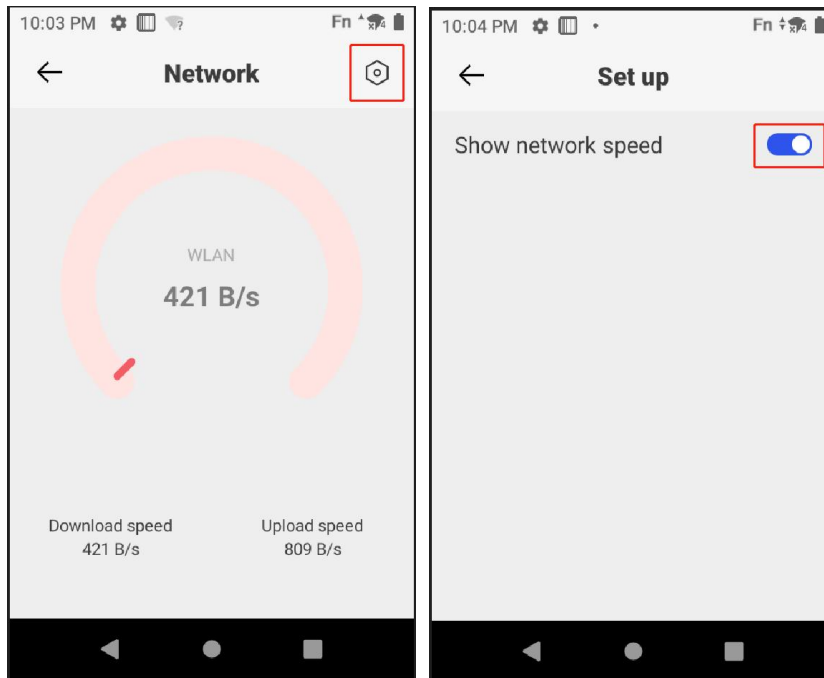

3.9 Data

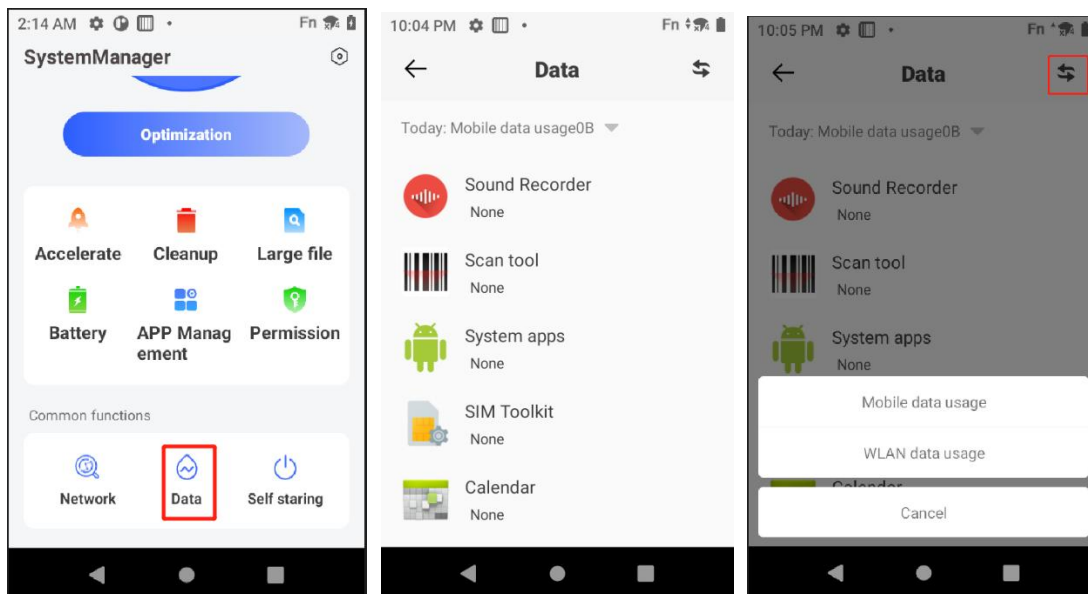

Commonly used functions - traffic statistics module to query mobile network traffic or WLAN traffic usage, the traffic used by the application is sorted and displayed, and you can choose to view the relevant application traffic usage statistics of the current day, yesterday, this week, last week, this month, and last month , click the button in the upper right corner to switch between viewing mobile network traffic or WLAN traffic.

3.10 Self starting

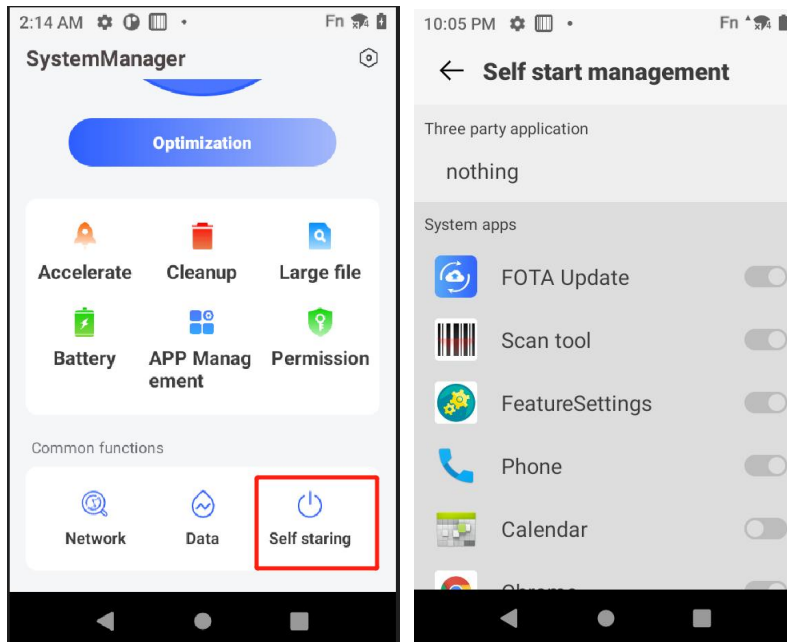

Common functions - the self-starting module can be set to automatically start the third-party applications installed afterward.

3.11 Fall statistics

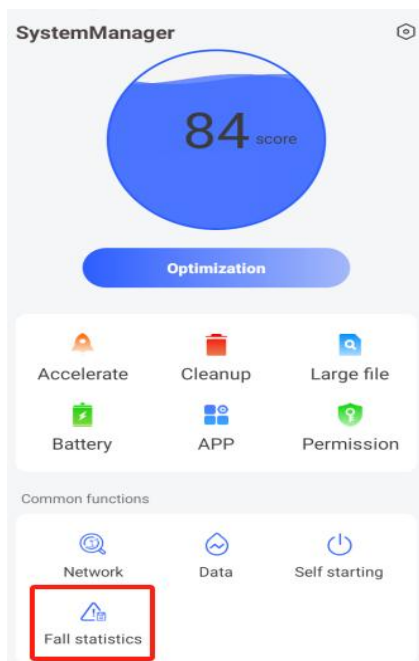

Through the device acceleration sensor and related algorithms in the detection of the device generated free-fall type fall record statistics related to the fall data, including fall time, fall height, fall latitude and longitude and other data.

3.12 Set up

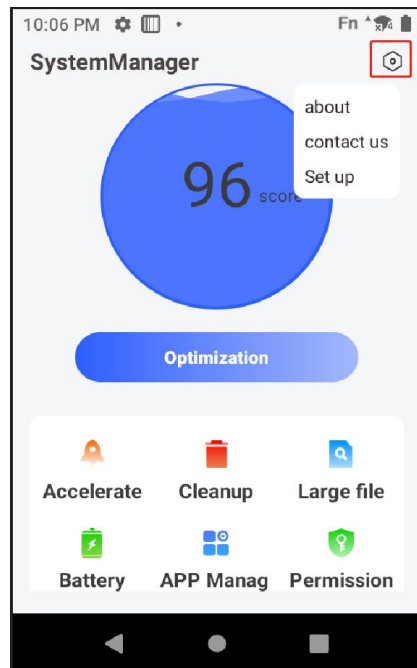

Click the button in the upper right corner of the main interface to enter "About" to query the software version; enter "Contact Us" to submit relevant usage suggestions or feedback; click "Set up" to configure application-related parameters.

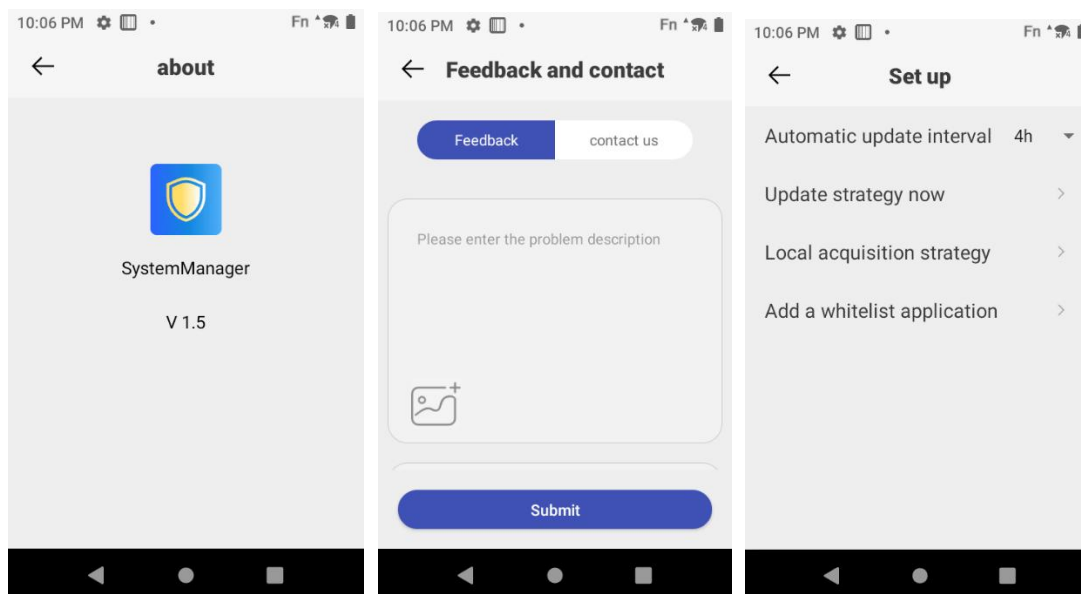

- Automatic update interval: After opening the background management system, the cleaning strategy can be issued. Here, the automatic update interval can be set, and you can choose 2, 4, 6, and 8 hours. In addition, the configuration here is also used to detect whether the system manager APP needs to be updated (the update is automatically downloaded and installed to complete the update);

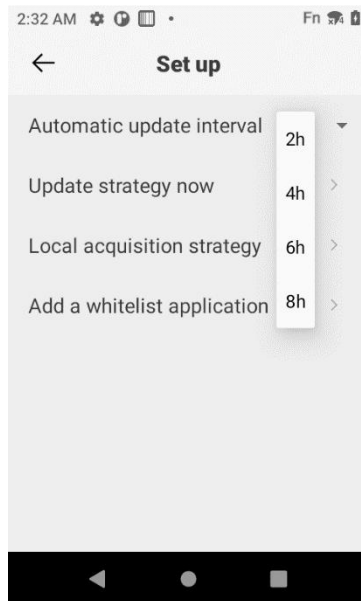

- Update the strategy now : actively obtain the cleaning strategy from the background management system;
- Local acquisition strategy: The background management system can export the cleanup strategy file, which can be sent to the relevant path of the device through the data line. Click to obtain the policy locally to enter the file manager, and select the policy file (txt) to import the policy;
- Adding whitelisted applications : After opening the background management system, you can configure whitelisted applications and display them here. In addition, you can click the Add button to manually configure and choose to add whitelist applications.

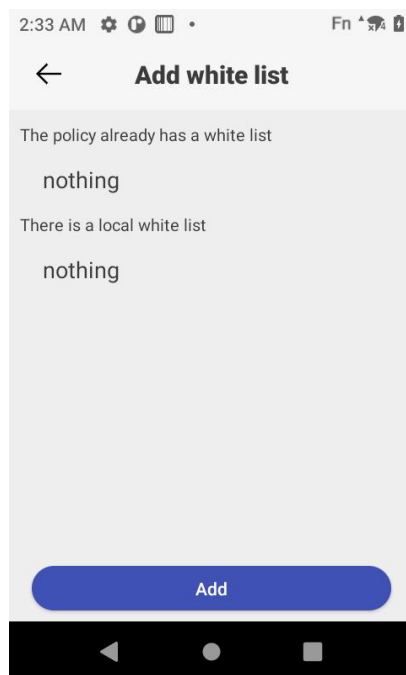

*The content described in this document may be different from the actual function and interface, and the final interpretation right belongs to SEUIC.